

# RIVIERA SUITE

2020

2 bedrooms  
4 beds  
28.90 m<sup>2</sup>  
8.04 x 4 m



The Riviera Suite is shown with 4 Linen sides  
Overall Dimensions. Usable interior floor area. Height 3.49 m

**The large 2-bedroom model with its summer kitchen that opens directly onto the outside and its vast master suite.**

- ✦ 1 double-opening and one fixed bay window
- ✦ 1 Master bedroom with en-suite shower room
- ✦ 1 spacious and light living room with separate areas: kitchen and lounge

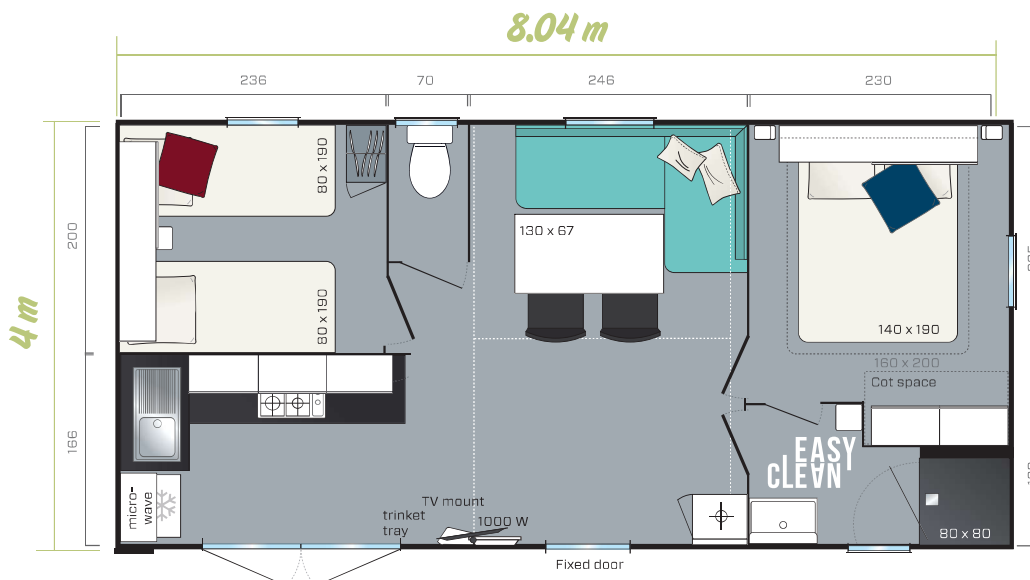

## Standard fittings

- Smoke detector - guaranteed for 10 years
- 100% LED indoor lighting
- 1000 W convector
- 35kg/m<sup>3</sup> HR Foam mattress with the OEKO-TEX label.
- High and low vents
- Phthalate-free lino
- Central circuit breaker
- Aerial socket and TV cabling
- Kitchen units on feet with PVC plinths
- Flow reducers on sink and washbasin mixer taps (7 l/min)
- Top-of-the-range, ACS-certified mixer taps
- Natural draught gas boiler with pilot light (14 kW)
- Environmental awareness sticker to encourage ecological behaviour

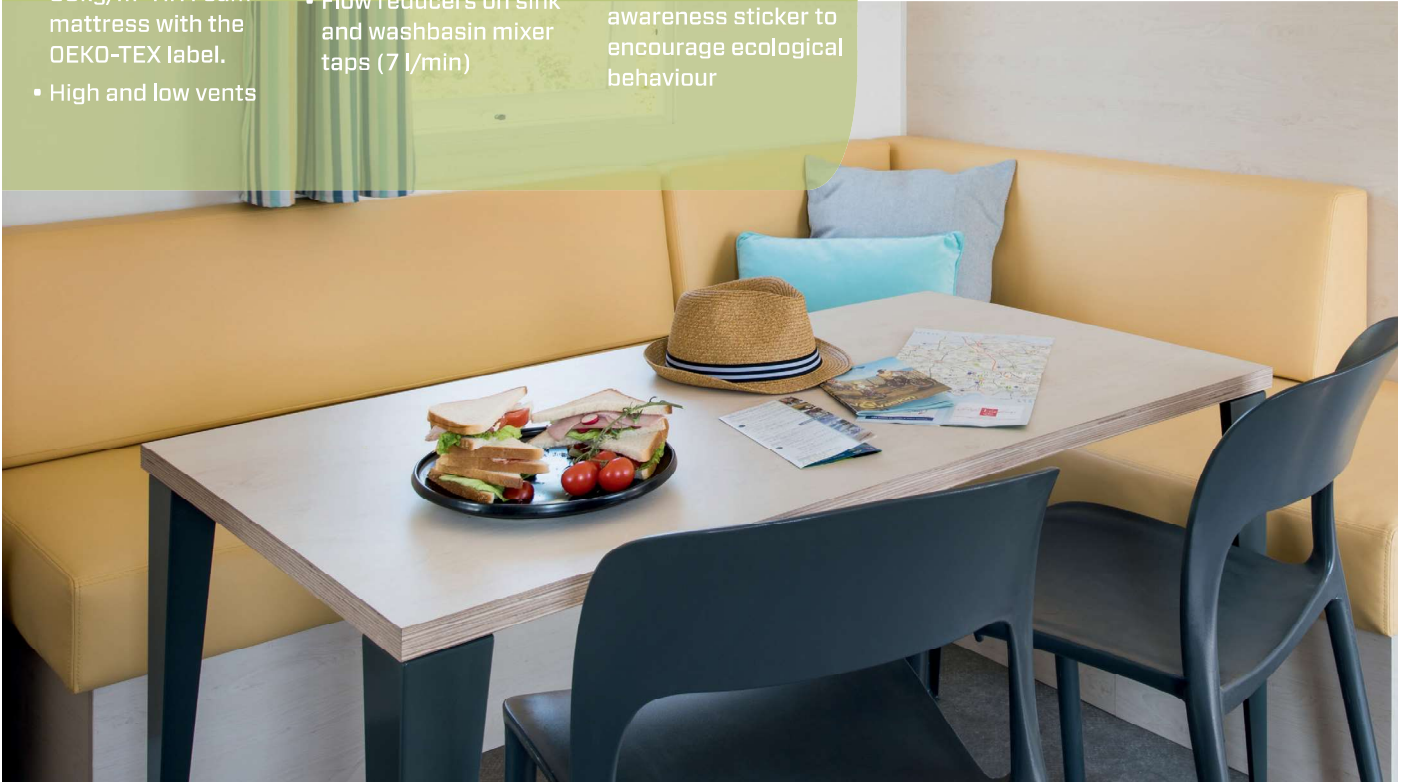

### Kitchen

- Microwave oven cabinet
- 3 pan drawers
- White, 4-burner gas hob
- 115 L, class A+ table top fridge

### Master bedroom

- En-suite shower room
- Shelves in the headboard topped with an overhead cabinet with sliding door
- Adjustable reading lights with integrated on/off switch
- 2 wall-mounted metal bedside tables
- 18 slat bed frame with raised legs and 35 kg/m<sup>3</sup> HR foam mattress
- Blackout curtain
- High storage cabinets at the foot of the bed

### Living room

- Dining table with fixed anthracite lacquered legs
- Large L-shaped bench seat
- 2 grey in&out folding chairs
- TV bracket

### Shower room

- Easy Clean shower room that is designed to be durable.
- 80x80 cm shower tray with smooth, extra flat floor
- Wall-mounted washbasin with built-in towel rail and shelves
- Modern design corner shelf
- Window with frosted glass for optimal privacy
- Dual volume toilet cistern (3/6 litres)



### Children's/guest bedroom

- Overhead cabinet with sliding door
- Metal bedside table to be installed
- Wardrobe
- 18 slat bed frame with raised legs and 35 kg/m<sup>3</sup> HR foam mattress
- Blackout curtain

## The ideal options

- Combination blackout blind and mosquito screen
- French window instead of the fixed bay window
- High transverse bed to offer more space or more sleeping capacity.
- Spare bed in the bench seat
- 500 W convector heater in the bedrooms and the shower room

